

Purpose: To understand patient move day.

1 Move Timeline - **EXACT TIMES AVAILABLE AT THE NURSES STATION ON PD1**

	Track 1	Track 2	Track 3	Track 4	Track 5
500P 9:00-12:30	D1CCU E29 E2	B1 B3 D3 G25	C3 B2 DGR	E3 F3	C2 D2 G1 H1
300P 11:30-13:00		B1	C3 B2 DGR D1CSU	FGR E3 F3 E1	C2

2 Inpatient Move: Imperatives

- ✓ First patient moves at 0900
- ✓ 500P Interventional Platform activates at 0700
- ✓ Complete rounds early
- ✓ Expedite orders in Epic
 - Write discharge and downgrade/transfer orders as early
 - Of note, STAT orders delay transfers
 - Complete Non-urgent orders pre/post move (imaging, lab work, etc)
- ✓ STAT tests/procedures = existing process
- ✓ Move sequence posted at 300P patient care station
 - Coordinate care with times listed
- ✓ Normal communication and escalation processes
- ✓ Escalate concerns to nursing ASAP

3 ED Cutover

- ✓ 500P ED opens as an adult ED at 0700
- ✓ 300P ED will operate as Pediatric ED at 0700
- ✓ Both 500P and 300P will operate at full capacity

4 500P Interventional Platform Kickoff

- ✓ 500P Int. Plat. opens at 0700 to support Trauma, 300P closes for weekend (11/17)
- ✓ 500P and 300P Int. Plat. have a normal case schedule (11/18)

5 Additional Information (inpatient moves)

- 5 Patient Move Tracks - 1 ICU Track. 4 AAU Tracks.
- Patient move is 4-6 hours
- Patients staffed 1:1 with nurses

6 Personal Information

- Lunch stored in breakroom
- Personal items stored in Team Room

Questions: Contact Jake Shepherd 650-483-9098

1 Interventional Platform Map

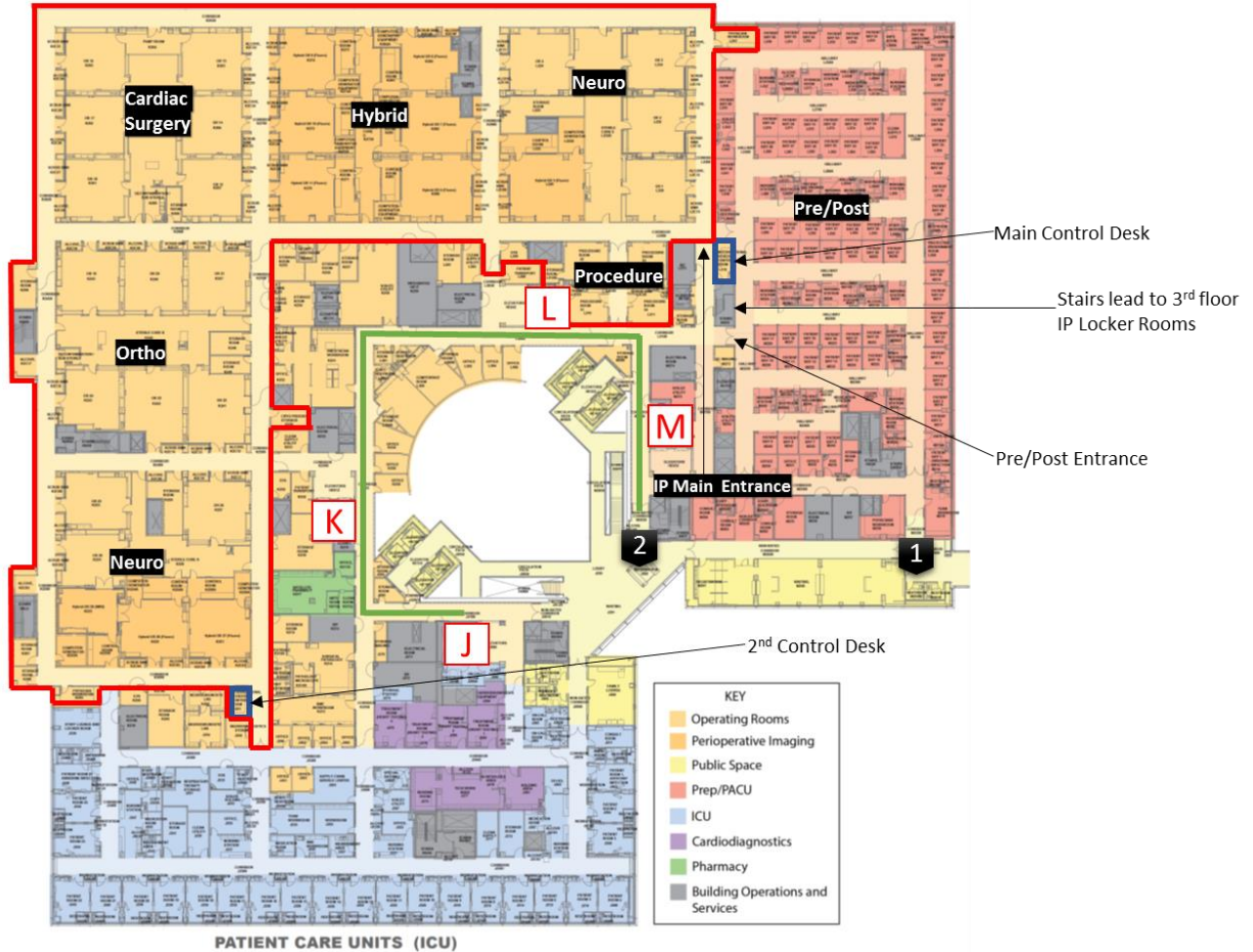

2 500P Interventional Platform Kickoff

- ✓ 500P Int. Plat. opens at 0700 to support Trauma, 300P closes for weekend (11/17)
- ✓ 500P and 300P Int. Plat. have a normal case schedule (11/18)

3 Hours and Contact Information

- ✓ 500P - 24/7
- ✓ 300P & Lane – 0700-1900 Monday-Friday
- ✓ IPOC Direct Line: 1-650-736-5693 (TP Line in L200)
- ✓ Badge Access Issues: Access forms will be kept at Control Desks

4 Bouffant Color Identification

- ✓ Pink – IP area wayfinding contacts
- ✓ Green – IT/BioMed Support
- ✓ Red - Vendors